

KombiSIGN 71 / WIN

**WIN ethernet receiver 115-230VAC BK**

Part No.: 860.000.07

**MECHANICAL DATA**

Length	80 mm
Width	76 mm
Height	30 mm
Materials	ABS
Housing colour	Black
Protection category	IP20
Connection	USB
Working temperature minimum	0°C
Working temperature maximum	+40°C
Weight with packaging	423 g
Product weight	378 g

**ELECTRICAL DATA**

Operating voltage	115-230V
Operating voltage type	AC
Operating voltage frequency	50Hz at 230V 60Hz at 115V
Operating voltage tolerance	+/- 10%
Rated operational voltage	230 VAC
Rated operational current	160 mA
Rated inrush current	800 mA
Protection class	Protection class 2
Pollution degree	2
Overvoltage category	II
Isolation voltage	U <sub>i</sub> = 250V; U <sub>imp</sub> = 2.500V
connectivity	Ethernet WIN

**APPROVAL DATA**

Conforms with CE	No
WEEE	Yes
Conforms with RED directive	Yes
Conforms with ATEX-directive	No
Conforms with CCC	No
Conforms with UL	No
Conforms with FCC	Yes
Conforms with IC	Yes
EAC certificate available	Yes
Conforms with AS-I	No



For additional installation and mounting information, refer to the appropriate user guide at [www.werma.com](http://www.werma.com). This printed copy is for information only and is subject to alteration.

KombiSIGN 71 / WIN

**WIN ethernet receiver 115-230VAC BK**

ICAO Certification	No
Conforms with DNV	No
Conforms with RoHS CN	No
Conforms with VdS	No

**DRAWING**

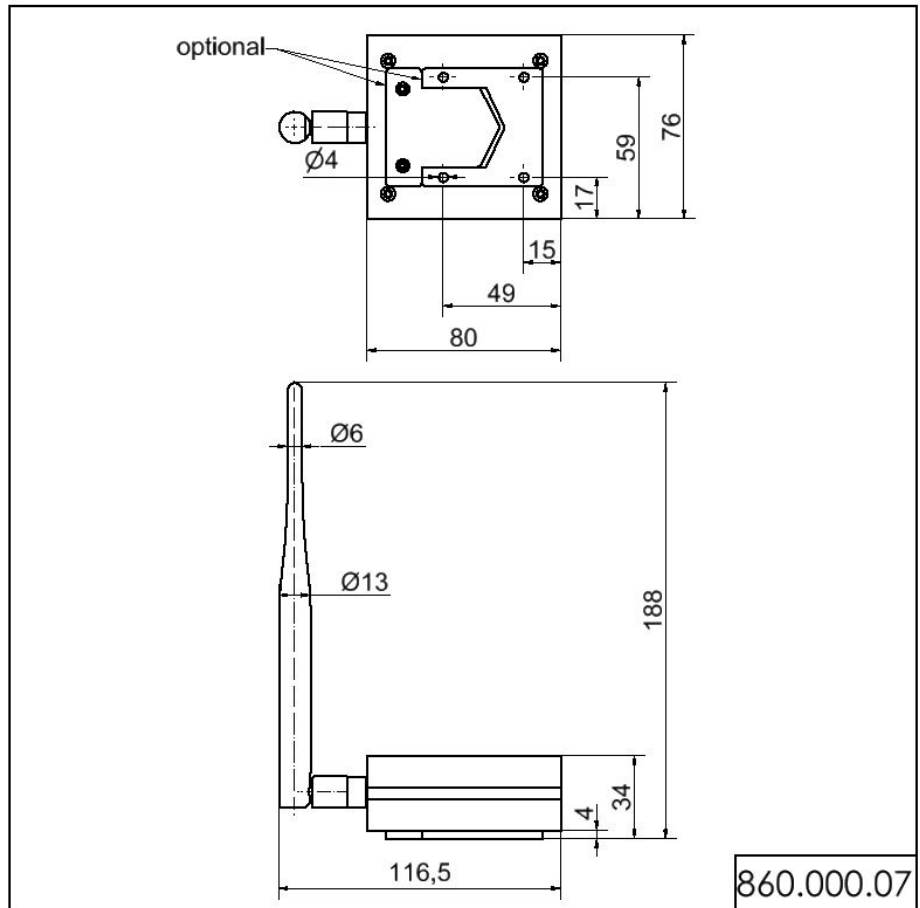

860.000.07

! For additional installation and mounting information, refer to the appropriate user guide at [www.werma.com](http://www.werma.com). This printed copy is for information only and is subject to alteration.